

## Westminster Seating

Westminster is a range of simple, linear concrete seating elements available in a variety of sizes and finishes. Manufactured from precast concrete with a dressed finish as standard. Please note that all concrete products are sealed prior to dispatch.

### Customisable options include:

- Colour: Light Grey. Buff. White. Black.
- Finishes: Light Exposed Aggregate. Fully Polished. Polished Top.
- Timber topper
- Anti-Skate studs

### Advantages of this design include:

- Consistent look with matching planter
- Made from robust concrete
- Low maintenance

### Seating is ideal for:

- Public spaces
- Health Care
- Universities

Standard sizes starting at L: 1800mm x D: 600mm x H: 450mm x  
Weight: 1135kg

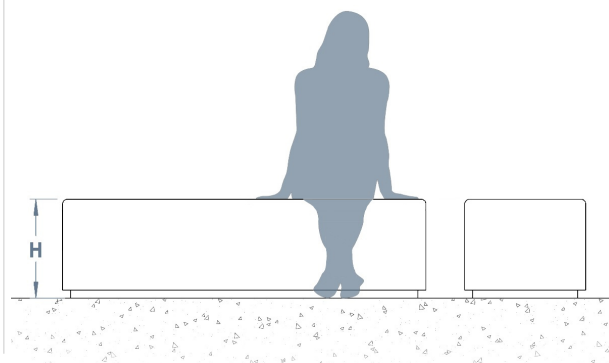
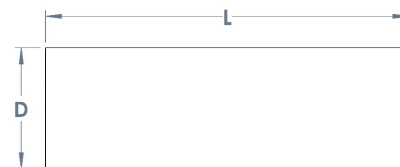

## Materials, Finishes & Options

**Concrete**  
Available in the options below;  
for further details on our **Concrete**  
visit our **materiality page >>**

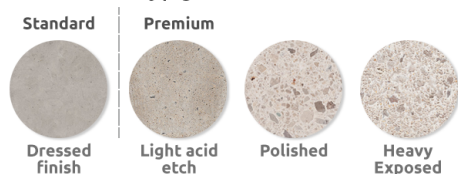

**Concrete colours**  
Available in the options below;  
for further details on our **concrete colours**  
visit our **materiality page >>**



**Fixtures**  
This product can be customised with a range of optional  
fixtures. If you have any further bespoke requirements  
**get in touch**, our sales team will be happy to help.

